

# BIO-WASTE COMPOSTER

MODEL.G601U-2K / G601N-2K



**ROKH SRL**

Published in December 2023, User Manual 2nd Edition



All Things Live Forever And In Harmony With The Earth

# **Feed Your Garden by turning Bio-Waste into Organic Compost**

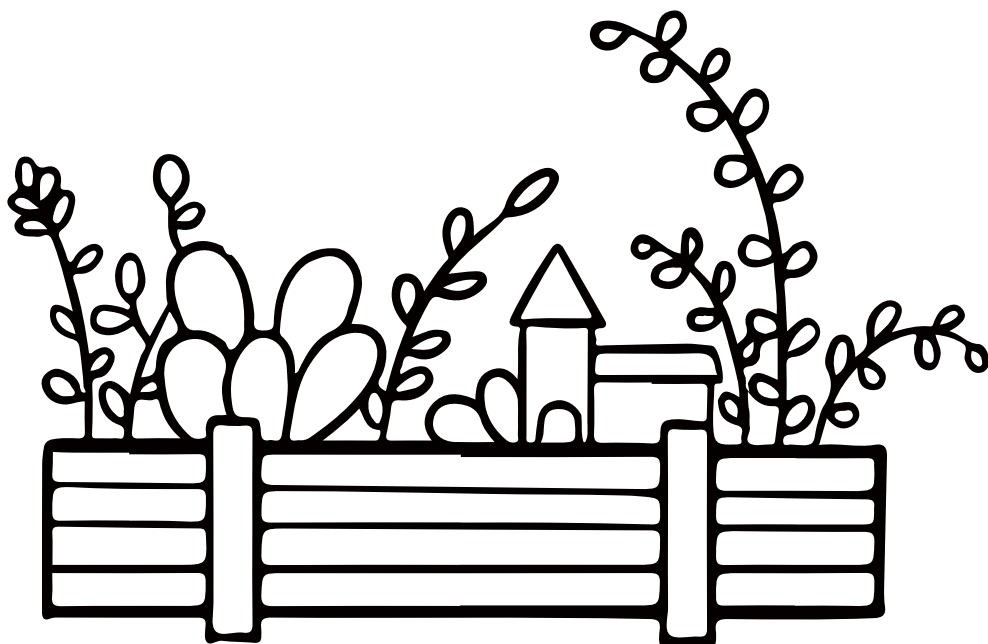

# Contents

## **Important Safety Instructions** **03**

### **Meet GEME**

- Operation Principle
- Product Packaging Information & Specifications
- Operation Principle
- Name Of Parts
- Dashboard

**05**

### **Use My GEME**

- Installation Precautions
- Preparation Before Use
- Guidelines Of Daily Use
- Guidelines Of Non-Use

**09**

### **Use My GEME By-Products**

- What Are By-Products?
- When To Remove By-Products?
- How To Store By-Products?

**10**

- When To Add GEME Kobold?
- How To Use By-Products?

### **Take Care Of My GEME**

- How to Clean Filter Net
- UV-Lamp Replacement
- Trouble Shooting
- Confirm Before Reporting The Fault

**13**

### **Product Quality Assurance &After-Sales**

- Warranty
- Repair Requests

**21**

### **Waste Appliance Processing**

- Material Identification
- Processing Steps

**21**

*Please carefully review the following instructions before use:*

*This manual includes the GEME warranty.*

*The warranty does not cover non-GEME branded products, even if packaged or sold with GEME hardware.*

*This warranty is subject to the laws of the country where the GEME product was purchased.*

*Warranty service is restricted to available options in the country where the service is requested.*

*Service options, part availability, and response times may differ by country.*

# Important Safety Instructions



**warning**

\*Your safety is our priority. Please follow these simple guidelines for the bio-waste composter to ensure safe and effective use.

Read and follow the precautions diligently for proper machine usage.

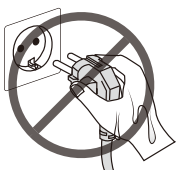

## 1. Prohibition of Wet Hands

Strictly avoid touching and operating the power plug and socket with wet hands. (may cause electric shock)

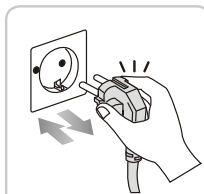

## 6. Plug and Socket Operation

When connecting or separating the plug and socket, grasp and operate the handle. (risk of electric shock if the wire is damaged)



## 2. Certification and Grounding

Ensure that the power plug and socket are CE-certified and properly grounded. (use of non-CE-certified products may lead to product failure, fire, and accidents)

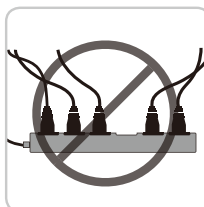

## 7. Avoid Overloading

Refrain from connecting multiple electrical appliances on one plug board simultaneously. (may cause overheating, overload, and fire)

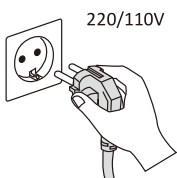

## 3. Voltage Requirements

This product requires the use of 220/110 volts of electricity. Before use, verify that the power supply voltage is correct. (Voltage discrepancy may lead to product failure)



## 8. Abnormal Product Operation

If the product exhibits abnormal behavior or emits a smell (smoking, burning odor), unplug the power cord. (fire and electric shock hazards; contact after-sales center for repair)



## 4. Handling Power Cord

Avoid having the power cord and plug/socket pinned down by heavy objects and keep them away from sharp objects. (prevents electric shock and fire hazards)

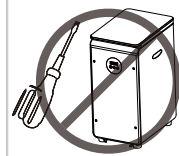

## 9. Unauthorized Disassembly

Strictly forbid self-disassembly or modification of the product, except by company after-sales technicians. (may cause fire, electric shock, injury, etc.)



## 5. Damaged Power Line

If the power line is damaged seek assistance from qualified maintenance or the after-sales service center for repair.

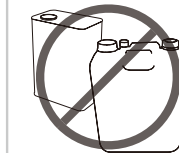

## 10. Avoid Flammable Substances

Do not use flammable substances such as gasoline when cleaning products. (may cause explosion, fire, etc.)

# Important Safety Instructions



## 11. Children and Microorganisms

Do not allow children to touch or ingest microorganisms. (may cause health damage)



## 15. Children and Product Interaction

Do not allow children to climb onto the product or play with it. (may cause serious trauma)

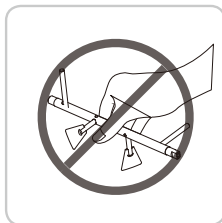

## 12. Avoid Forceful Actions

Do not force the stirring blade inside the product. (may cause hand injury and product failure)



## 16. Caution Regarding Display

Do not allow children to touch the display. (may cause product failure or injury)



## 13. Foreign Objects in Decomposition Tank

Do not place hard foreign objects such as dishes, spoons and chopsticks in the product decomposition tank. (may cause overheating and product failure)



## 17. Avoid Hard Materials

Do not put hard materials such as beef bones, pig bones, chicken bones, etc. (may hinder stirring blade rotation and cause product failure)

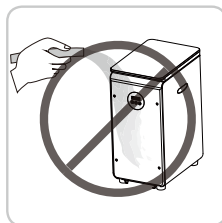

## 14. Avoid Water Directly for Cleaning

Do not use water for cleaning directly, as it may lead to product anomalies (risk of electric shock, fire, etc.)

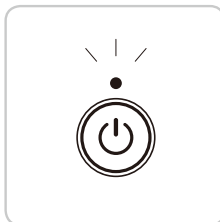

## 18. Keep the machine always on

24/7 continuous composting (Equipped with automatic energy saving mode )

Power Consumption Caution

If the lid is opened frequently, the power consumption may increase.

In temperatures below 3°C, increased power consumption may occur to maintain microbial temperatures; and condensation may occur from the air vents.

※ Failure to operate as described in this instruction will be regarded as the user's responsibility in the event of an accident.

## WHAT CAN GEME DO FOR YOU?



GEME replicates the entire natural composting process. It expedites the decomposition of bio-waste by creating an optimal environment for microbiota to break it down and multiply transforming it into natural organic compost within 6-8 hours.

GEME Kobold is an all natural high-temperature complex of microorganisms extracted from nature. It is non-toxic to the human body.

For more information please visit our website.

 [www.geme.bio](http://www.geme.bio)

# Operation Principle



1 Add bio-waste anytime.



2 Utilize mixing shaft rotation for thorough blending with microorganisms.

The control unit optimizes the microbial decomposition environment by regulating temperature and moisture.

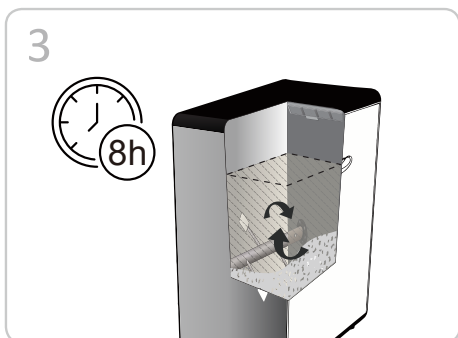

3 After 6-8 hours, microbiota breaks down bio-waste into 95% clean air and 5% by-products.

Filtration discharges the air, while by-products continue decomposing in GEME, regulating moisture and compost C/N ratio.

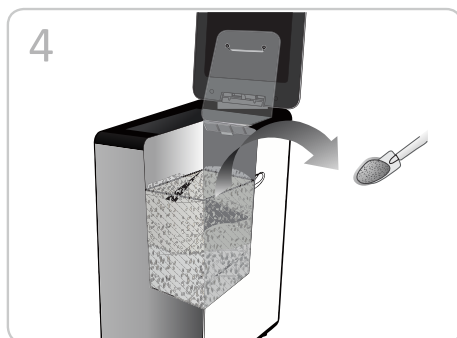

4 For a family of five, clear by-products every 2 months( cleaning intervals vary based on input amounts and compost extraction frequency).

When accumulation obstructs mixing blades relocate by-products to the mixing shaft position and utilize them in your plant.

# Product Packaging Information & Specifications

## Product packaging information

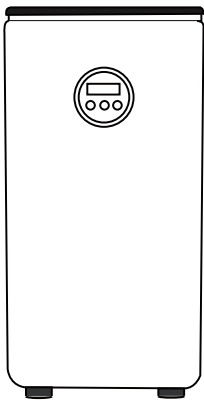

Bio-waste composter



Compost starter



Product instructions

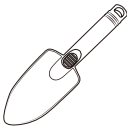

Shovel



Scraper

## Product specification

Specification	
Product name	Bio-Waste Composter
Model	G601U-2K/G601N-2K
Processing method	Microbial aerobic fermentation degradation
Decomposition capacity	5.0kg/day
Voltage	110/220V/50Hz~60Hz
Power max	0.43kWh
Purification method	Metal oxidation deodorization method
Size	320*455*665mm
Weight	19.5kg

# Name Of Parts

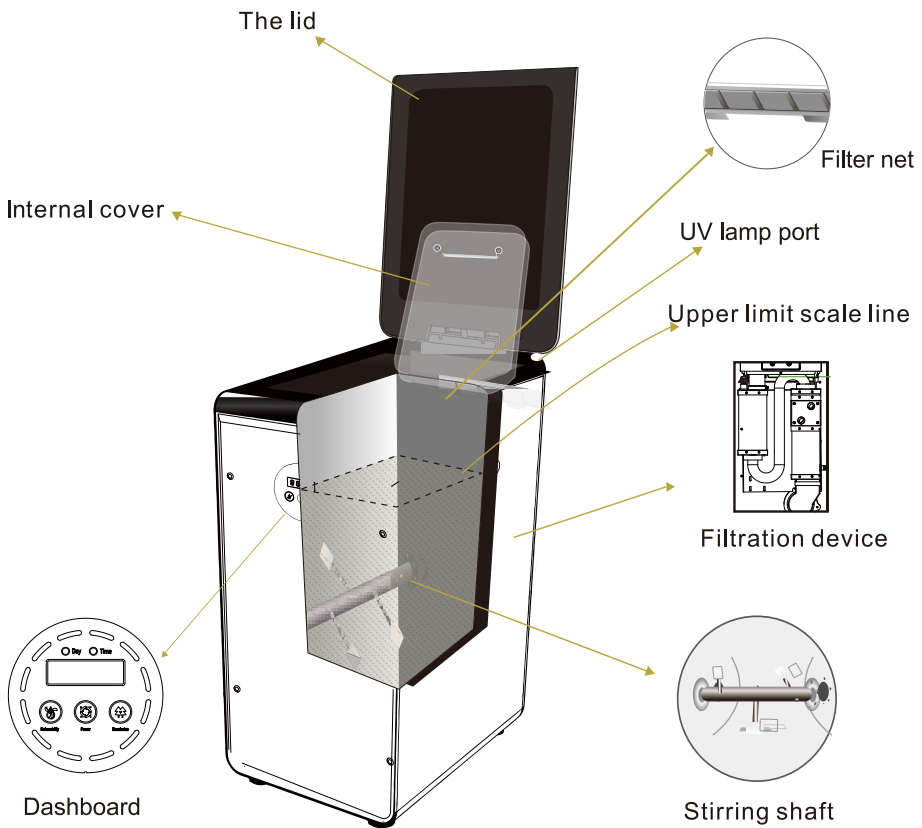

# Dashboard

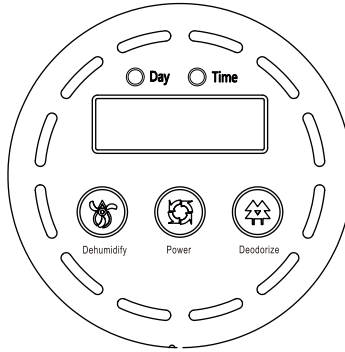

## • Key functions •



Dehumidify

### **Dehumidify Button**

- Press this button when condensation appears on the inner lid and the by-products are thick.
- The LED above the button illuminates, and it automatically enters standard mode after 24 hours.



Deodorize

### **Deodorize Button**

- Press this button when the smell of fermentation leaks to the outside.
- The LED above the button lights up, and it automatically enters standard mode after 24 hours.



Power

### **Power Button**

- Used to power on or off the device.

## • Screen display •

### **Open**

"OPEN" is displayed when the lid is opened. The device enters the intelligent protection state and the mixing shaft stops rotating.

When the lid is closed, the unit will automatically begin to run and the composting time will start again.

Exception: Dehumidification and deodorization functions are active.

### **Fault alert status**

When a fault occurs during the product's operation.

The display shows the error code, and the machine will continue to beep as an alarm.

Long-press the deodorize button for more than 5 seconds to silence the alarm sound but the display will still show the error code.

# USE MY GEME



# Installation Precautions



Please refrain from involving the elderly and children in the disassembly or installation of the product.



## Recommended Installation

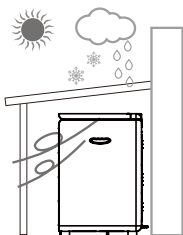

Choose a well-ventilated interior such as a balcony or kitchen.

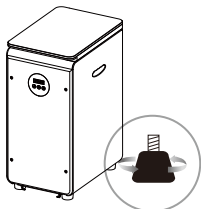

Ensure the installation on a leveled surface. In case of an uneven floor please adjust the footing.

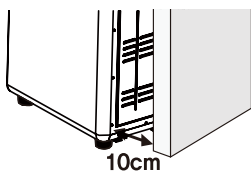

Maintain a distance of more than 10cm from the wall behind the product. (Ensure not to block the exhaust port of the product)



## Avoid Installing in the Following Manner

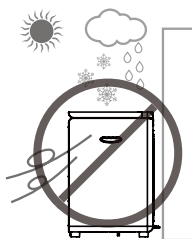

Outdoor or confined environments such as washrooms or bedrooms.



Areas are prone to water splashes, high humidity, or excessively low temperatures. (May lead to increased electricity costs and product failures)



Use the product to remove the foam.

# Preparation Before Use

Please store the instructions, shovel, and scraper appropriately after retrieving them.

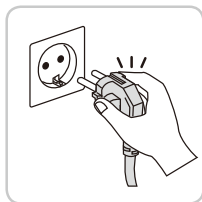

- ① Connect the power cord and verify that the product is functioning normally.

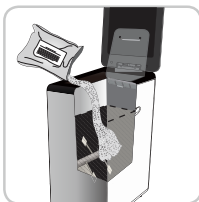

- ② Open the compost starter package and place all the compost starter into the mixing drum.



- ③ The compost starter are in a dry state. Activate them by pouring 800ml of water.



- ④ After the product has been powered on for 6 hours bio-waste can be introduced.

## Guidelins Of Daily Use

- Each input should not exceed 1kg, and the total daily input should not exceed 5kg. Ensure that the garbage does not surpass the maximum limit line inside the inner tank.
- If a muddy or sticky appearance is observed in the decomposition tank, it indicates excessive input. In such cases, suspend bio-waste disposal for 2 to 5 days, allowing the inside of the decomposition tank to dry before resuming use.
- When dealing with a substantial amount of bio-waste (e.g., during refrigerator cleaning), please segregate and handle it separately.
- Particularly when the waste contains higher water content (e.g., watermelon rind, etc.), please handle it separately.

## Guidelines Of Non-Use

### 1. Short-Term Non-Use:

When the product is not in use for a short period (e.g., during travel or a business trip), please refrain from unplugging it. The product will automatically enter energy-saving mode when it detects the absence of waste input.

### 2. Long-Term Non-Use:

If the product is not used for an extended period, unplug it and perform thorough cleaning.

- Once you confirm that bio-waste has completely decomposed, activate the dehumidifying mode to dry the by-products. Scoop out the dried by-products and seal them in a ziplock bag. The dried by-products can be reactivated for future use, so store them in a secure location.
- Disconnect the product from the power supply and clean the internal filter and inner cover following the provided cleaning instructions.
- Keep the emptied and de-energized GEME in a low-humidity, well-ventilated area.

# USE MY GEME BY-PRODUCTS



# What Are By-Products?

## **Waste Disposal:**

GEME by-products are general waste and fill-safe, they are not dehydrated burnt garbage.

## **Fertilizer Potential:**

GEME by-products enrich the soil for plant growth.

# When To Remove By-Products?

1. Remove when the mixing blades are not visible upon opening the lid. Take out the inner lid move by-products to the mixing shaft.
2. No need to clear all, they aid decomposition and adjust the compost C/N ratio.

**Note:** Dehumidify if by-products are too wet before removal.

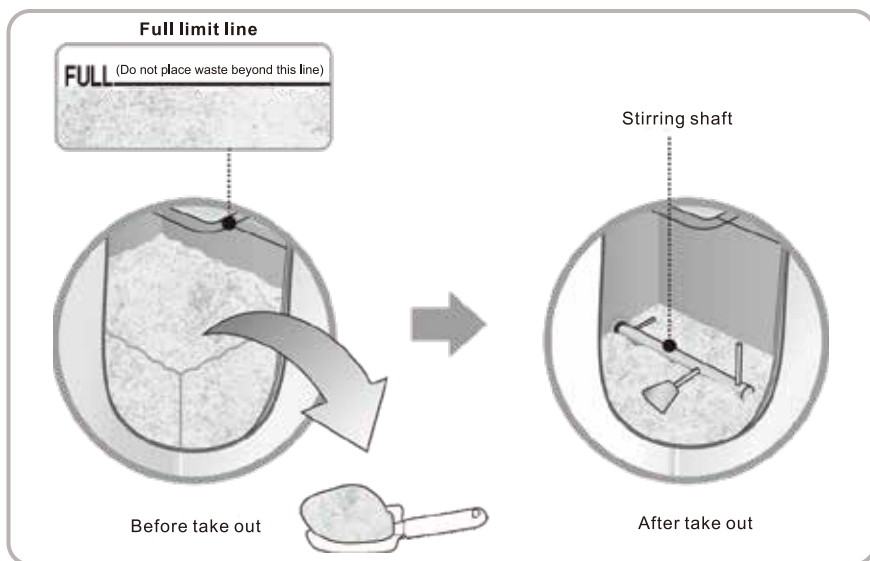

# How To Store By-Products?

**Store in a dark, sealed environment, avoiding exposure to air and moisture.**

1. Excessive moisture may attract pests such as cockroaches, flies, and mosquitoes necessitating drying for preservation.
2. Ensure secure packaging to prevent attraction to animals like cats, dogs, and mice.

# When To Add GEME Kobold?

**You have 2 choices.**

Option 1: Add a 20g GEME Kobold refill packet every two weeks after the initial by-product removal (move by-products to the mixing shaft) to maintain the activity of the microorganisms.

Option 2: If option 1 is not used in daily practice and you observe a significant slowdown in decomposition, replace the compost pile with a new 2000g GEME Kobold Compost Starter packet. Refer to "USE MY GEME".

# How To Use By-Products?

## • By-product processing instructions •

### **You have three options:**

#### **Blend with Soil**

Mix by-products with soil in a 1:8 ratio and use it. Cover with 2-3 cm of soil, water enough. Notice the fertilizer effect in about 2 weeks (summer) or 1 month (winter).

#### **Direct Application**

Use by-products directly, leaving roots 15cm.

#### **Save it for later**

Store organic compost in a cool place for 2 weeks, then spread it in your garden or on the grass.

*Whether you're growing fruits, flowers, or trees, our agronomists will showcase GEME Kobold's magic through videos. Follow us on social media or subscribe to our E-newsletter!*

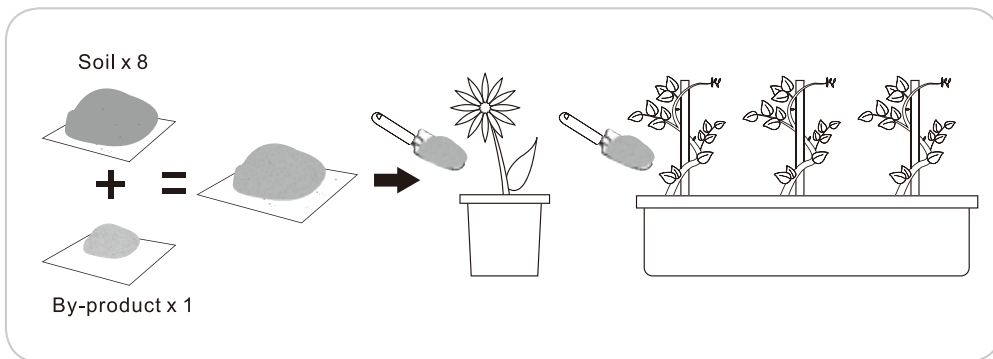

## • Managing white fungus in plant soil after compost use •

GEME breaks down organic waste, like food scraps, yielding nutrient-rich compost. This organic-rich compost may encourage beneficial fungi growth, some appearing white and mold-like. Additionally, compost application alters soil nutrient levels and pH influencing microbial activity and fostering the growth of existing fungi and mold spores of soil.

If you notice white fungus-like material in your plant's soil post-compost addition, follow these steps:

1. Identify Type: Determine if it's harmful mold or beneficial fungi. Some fungi are beneficial and require no action.
2. Adjust Watering: Water moderately to prevent overly wet soil conditions.
3. Modify Compost Usage: Adjust compost application amount and frequency.
4. Monitor Plants: If plants are healthy, no further action may be needed.

If a real mold issue negatively impacts plants, consider specific measures like soil replacement.

\*The company is not liable for any crop abnormalities resulting from by-product fertilization

# TAKE CARE OF MY GEME



GEME doesn't require cleaning after each use.

Clean residue on the inner walls and remove any fibrous items from the mixing shaft when taking out the compost.

For thorough cleaning, turn off the power, unplug the cord, and use a shovel to scoop out all by-products. Wipe the inner tank and outer walls with a damp cloth. Do not rinse with water

# How To Clean Filter Net

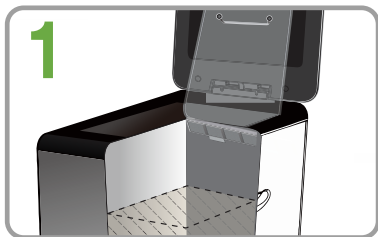

Clean promptly if dust is visible.  
Open outer cover, remove inner cover.

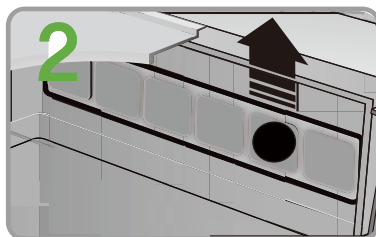

Pull exhaust filter upward as shown.

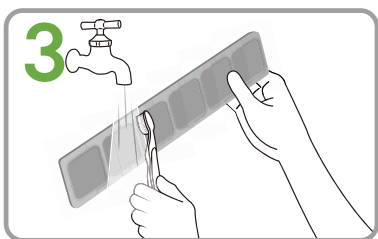

Diagonally rinse filter with water, clean foreign objects with a brush (e.g., old toothbrush).

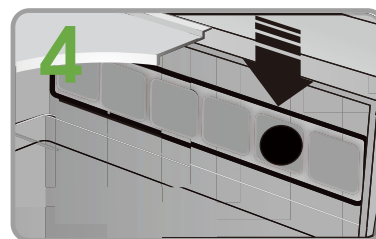

Reinstall clean filter as shown. Cover inner and outer covers, power on for normal use.

# UV-Lamp Replacement

The UV-lamp is vital for sterilization and deodorization.  
Replace it promptly if a fault code appears.

## • UV lamp fault alarm •

- Fault light illuminates.
- 3-minute continuous alarm every 1 hour.
- Long-press the deodorize button for more than 5 seconds to silence the alarm sound, but the display will still show the error code.

## • Replacement steps •

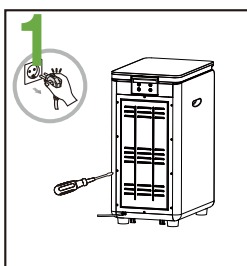

Unplug power. Use a Phillips screwdriver to loosen screws.

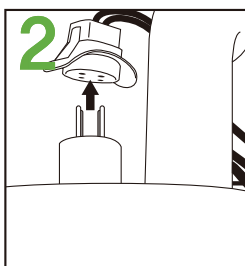

Separate lamp from holder (be cautious not to break it).



Open product lid; coin-sized area visible at top right inside lid. Push it out with fingers.

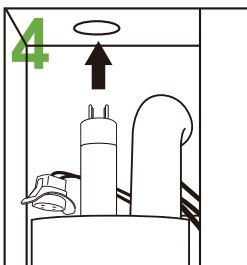

Pass old lamp through opening remove in order, and insert new lamp in original way.

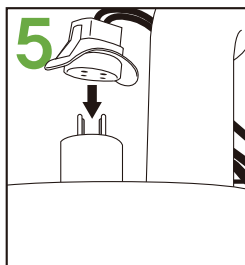

After connecting lamp and holder power on to check if UV-lamp is working. If normal, UV-lamp lights up with no error code.

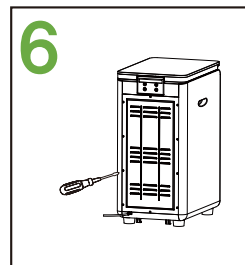

After disconnecting power, use a screwdriver to reattach back cover, screws, and change light area cover. Then, place machine, turn on power, and it can be used normally.



GEME utilizes specialized dual-band UV-lamps. For replacements please contact the after-sales center.

# Troubleshooting

Problems	Reasons/Discription	Solution
<b>No power after pressing the power button</b>	Check plug and socket connection	Connect plug to socket properly
	Verify power: 110/220V	Use 110/220V voltage
	Product anomaly.	Contact after-sales service center.
<b>Warning sound</b>	During operation issues, operation aborts, wrong component indicator and "fault" light on, continuous "bibibi" warning sounds (3 minutes per hour)	Provide fault code to after-sales service or customer service center
<b>Noise</b>	Check for hard objects in the decomposition tank	Remove hard objects
	Intermittent "du" noise when decomposition tank is too dry	Add 200 to 500 ml of water or use bio-waste with more water
	Periodic noise during stirring motor operation indicates motor abnormality	Contact after-sales service center
	Continuous noise due to abnormal fan	Contact after-sales service center
<b>A bad smell</b>	Abnormal fermentation by anaerobic microbes during bio-waste degradation	Pause add waste for 2-5 days, activate deodorizing function; if issue persists, empty inner drum and replace compost starter
	Weak odor indicates incomplete deodorizing	Press the "Deodorize" button
	By-product odor is fine, but external odor leakage suggests deodorization unit abnormality	Contact after-sales service center.

Trouble Codet		Fault Description
E1		UV-lamp malfunction
E2		Fan malfunction
E3	E31	Motor malfunction
	E32	
	E33	
E4	E41	Heating element malfunction
	E42	
	E43	
	E44	
E5		UV-lamp+Fan malfunction
E6		UV-lamp+Motor malfunctiont
E7		UV-lamp+Heating element malfunctiont
E8		Fan+Motor malfunctiont
E9		Fan+Heating element malfunctiont
E10		Motor+Heating element malfunctiont
E00		3 (and more) components malfunction

# Confirm Before Reporting The Fault

Problems	Reasons/Discription	Resolution
<b>Not stirring</b>	Occurs with excessive by-products	Removal of by-products to the mixing shaft position
	Not stirring when the internal state is thick	Pause garbage input for 2-5 days resume after drying
	Motor failure	Contact after-sales service center
<b>Unable to ferment and decompose bio-waste</b>	Excessive biowaste input (average daily treatment capacity of 5 kg)	Pause garbage input for 2-5 days, resume after drying
	Slow decomposition rate of fiber-rich and fruit pulp bio-waste	Cut the fiber-rich bio-waste into small pieces to accelerate decomposition or allow additional time for decomposition
	Caused by abnormal agitator motor leading to insufficient agitation.	Stirring motor failure, please contact the after-sales service center
<b>By-product are too wet (slushy)</b>	Excessive biowaste input (average daily treatment capacity of 5 kg)	Pause garbage input for 2-5 days resume after drying
	Excessive moisture content in biowaste	
	When bio-waste is not fully decomposed, and the power is turned off.	Plug in and use for 1-3 days to return to normal condition
<b>Condensation inside the lid (small water droplets)</b>	Excessive biowaste input	Press the dehumidify button and refrain from putting in bio-waste for 2-3 days
	Occurs in cooler environments especially during winter	Please move GEME indoors
	Occurs when used without removing the foam pad under the product	After removing the foam pad, press the dehumidification function button
	Occurs when the exhaust filter in the decomposition tank is clogged	Please clean the exhaust filter
<b>Insects in the product</b>	Occurs when the power is turned off	Replace with new Microorganisms
<b>By-products are too dry</b>	The amount of bio-waste is too small	Pour about 200 ml of water or add a proper amount of soup when putting in bio-waste

# PRODUCT QUALITY ASSURANCE & AFTER-SALES

## Warranty

Warranty details are in the manual, certificate, and official website.

One-year warranty from purchase (except for non-family use).

## Repair Requests

Troubleshoot using manual.

If the issue persists, contact the dealer or service center or submit an after-sales service form online

**For more information, please visit the official website.**

 [www.geme.bio](http://www.geme.bio)

# WASTE APPLIANCE PROCESSING

## Material Identification



Easily identify synthetic resin materials.

## Processing Steps

New product purchase includes free used appliance service.

For disposal, contact the dealer or service center for paid services.

### ANNEXE:

- What Can I Put In My GEME
- GEME Quick Start Guide
- Warranty





 **ROKH SRL**

 Bd Louis Schmidt 29  
1040, Brussels  
Belgium

 [www.geme.bio](http://www.geme.bio)

 [info@geme.bio](mailto:info@geme.bio)

 Whatsapp: +1(669)307-9714

